

EXTERIOR

CONTENTS

GENERAL	2	REAR WIPER AND WASHER	
Outline of Changes	2	<HATCHBACK>*	9
FRONT BUMPER	2	HEADLAMP WASHER*	11
REAR BUMPER	3	MARKS	12
MOULDING	4	DOOR MIRROR	15
WINDSHIELD WIPER AND WASHER*	7		

WARNINGS REGARDING SERVICING OF SUPPLEMENTAL RESTRAINT SYSTEM (SRS) EQUIPPED VEHICLES

WARNING!

- (1) Improper service or maintenance of any component of the SRS, or any SRS-related component, can lead to personal injury or death to service personnel (from inadvertent firing of the air bag) or to the driver and passenger (from rendering the SRS inoperative).
- (2) Service or maintenance of any SRS component or SRS-related component must be performed only at an authorized MITSUBISHI dealer.
- (3) MITSUBISHI dealer personnel must thoroughly review this manual, and especially its GROUP 52B – Supplemental Restraint System (SRS) before beginning any service or maintenance of any component of the SRS or any SRS-related component.

NOTE

The SRS includes the following components: SRS-ECU, SRS warning lamp, air bag module, clock spring and interconnecting wiring. Other SRS-related components (that may have to be removed/installed in connection with SRS service or maintenance) are indicated in the table of contents by an asterisk (*).

GENERAL

OUTLINE OF CHANGES

- The service procedures for the front and rear bumpers have been revised due to their new design.
- The service procedure for the side protector mouldings has been revised due to their new design.
- The service procedure for the windshield wiper and washer has been revised as the windshield washer hose and nozzles have been changed.
- The service procedure for the rear wiper has been revised due to the change in the rear wiper motor and arm blade.
- The service procedure for the headlamp washer has been revised.
- The service procedure for the marks has been revised.
- The service procedure for the outside mirrors has been revised as tweeters have been incorporated.

FRONT BUMPER

REMOVAL AND INSTALLATION

Pre-removal and Post-installation Operation

- Front Under Cover Panel Removal and Installation

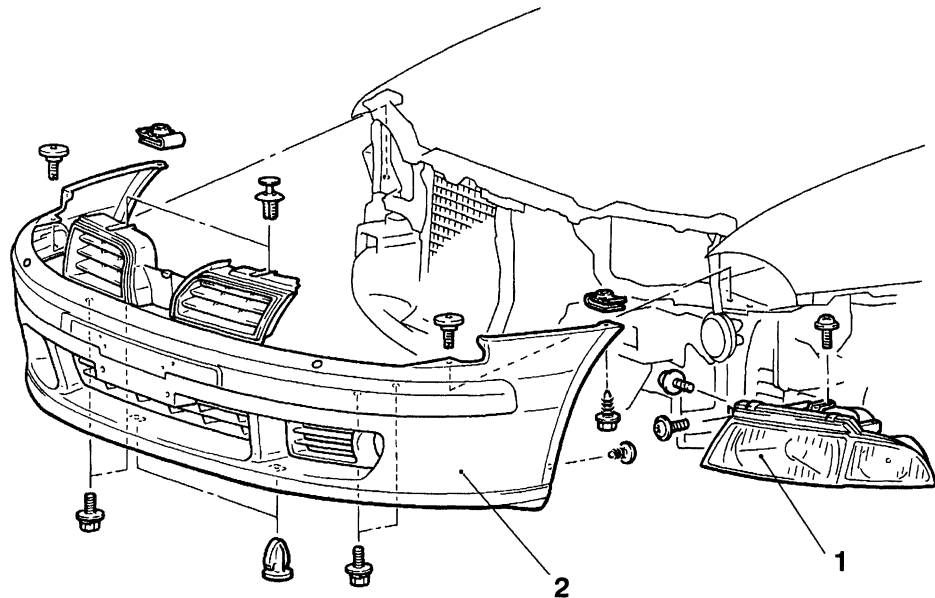

A18U0530

Removal steps

1. Head lamp
2. Bumper assembly

DISASSEMBLY AND REASSEMBLY

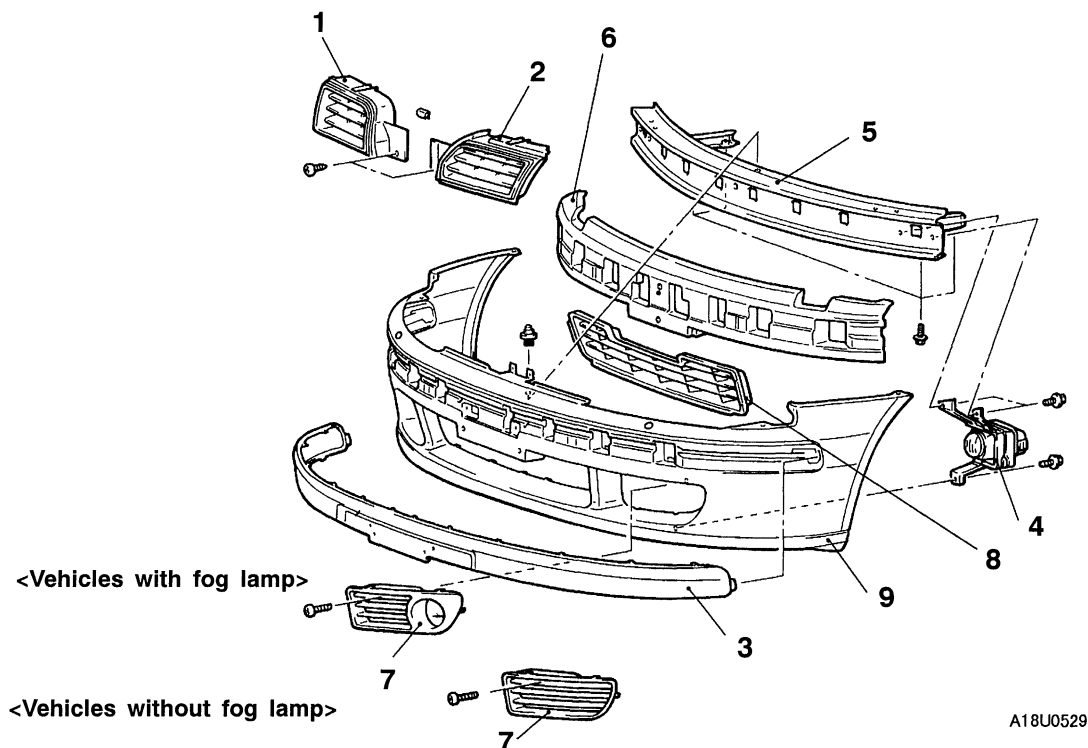

Disassembly steps

1. Radiator grille, R.H.
2. Radiator grille, L.H.
3. Bumper protector
4. Fog lamp
5. Bumper reinforcement

6. Form
7. Fog lamp cover
8. Under grille
9. Bumper face

REAR BUMPER

REMOVAL AND INSTALLATION

Pre-removal and Post-installation Operation

- Rear End Trim Removal and Installation
(Refer to GROUP 52A.)

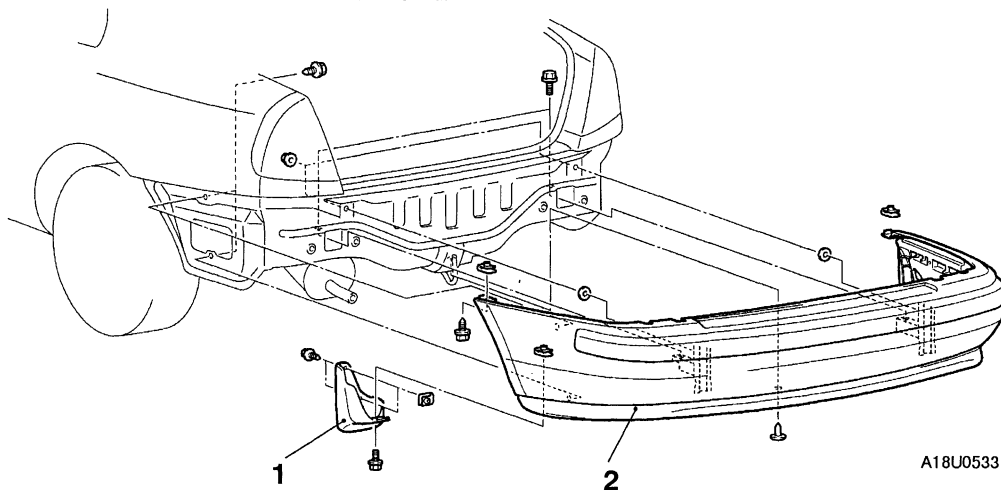

Removal steps

1. Rear mud guard
2. Rear bumper assembly

DISASSEMBLY AND REASSEMBLY

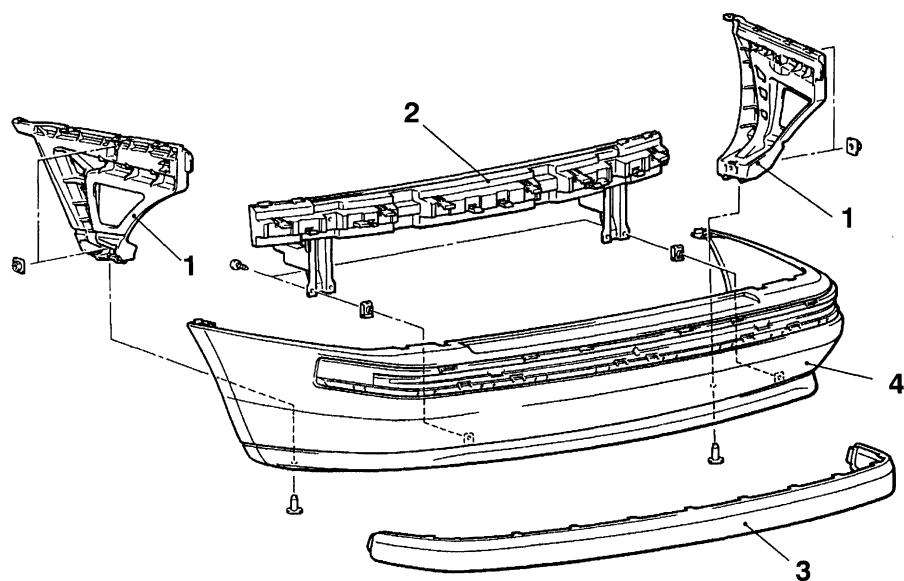

A18U0528

Disassembly steps

1. Side reinforcement
2. Bumper reinforcement

3. Bumper protector
4. Bumper face

MOULDING

REMOVAL AND INSTALLATION

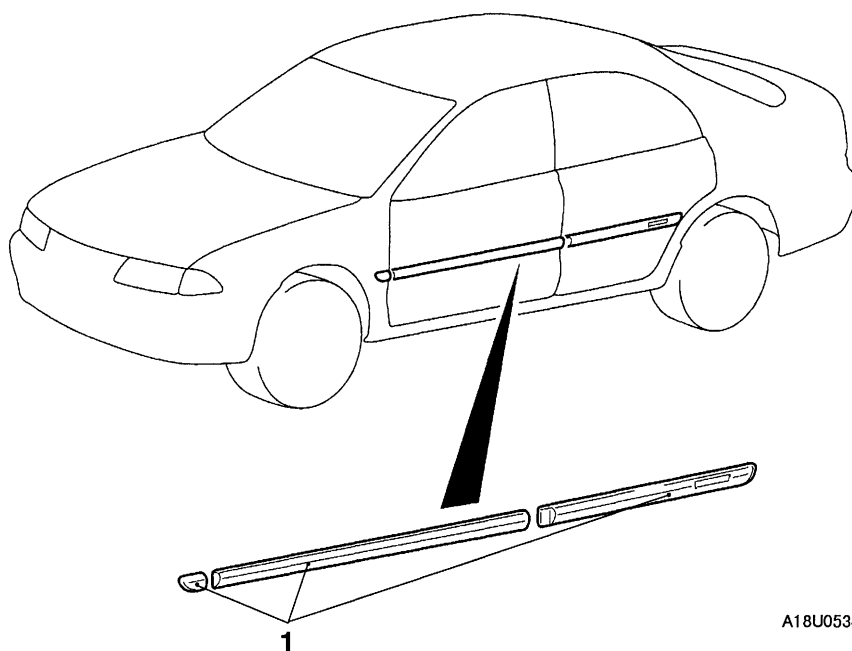

A18U0534

- ◀A▶ ▶A◀ 1. Side protect moulding

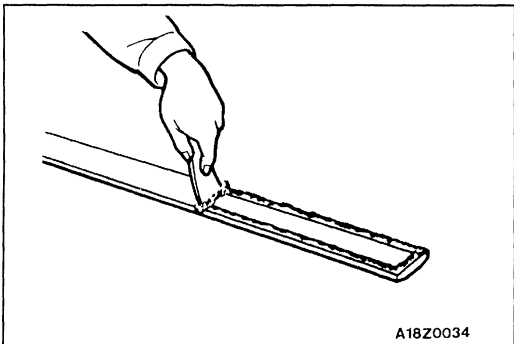
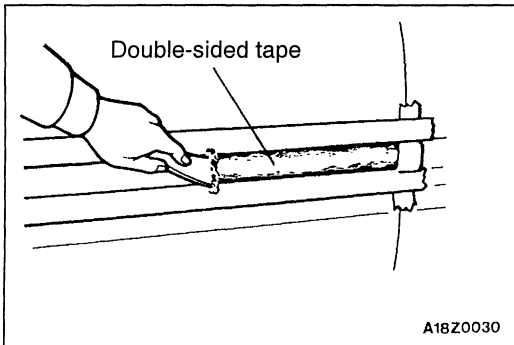
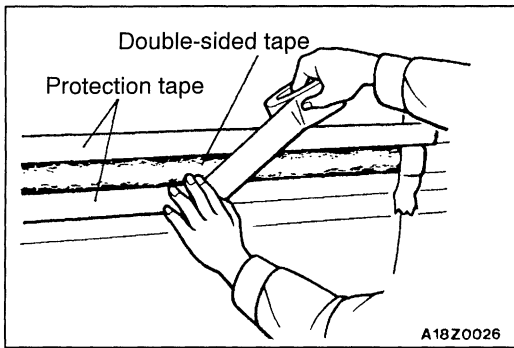

REMOVAL SERVICE POINT

◀A▶ SIDE PROTECT MOULDING REMOVAL

1. Attach protection tape all the way along the edges of the double-sided tape which is still adhering to the body.
2. Use a resin spatula to scrape off the double-sided tape.
3. Peel off the protection tape.
4. Wipe the body surface and clean it with a rag moistened with isopropyl alcohol.

INSTALLATION SERVICE POINT

▶A◀ SIDE PROTECT MOULDING INSTALLATION

Double-sided tape affixing to the side protect moulding (when reusing)

1. Installation procedure
 - (1) Scrape off the double-sided tape with a resin spatula or gasket scraper.
 - (2) Wipe the side protect moulding adhesion surface and clean it with a rag moistened with isopropyl alcohol.
 - (3) Affix specified pressure sensitive double-sided tape to the side protect moulding.

Specified adhesive tape:

Double-sided tape [10 mm wide and 1.0 mm thick]

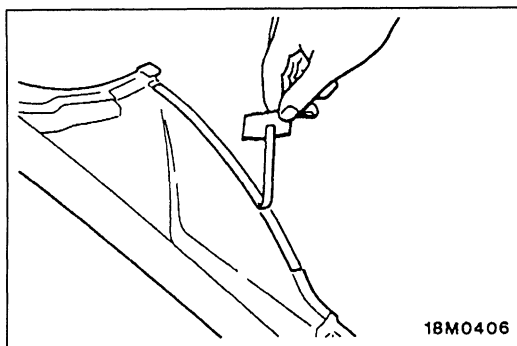

- (4) Remove strip paper from the pressure sensitive double-sided tape.

NOTE

Affix double-sided tape to the end of strip paper for ease of strip paper removal.

- (5) Install the side protect moulding.

NOTE

If it is hard to affix the pressure sensitive double-sided tape in winter, heat the application surfaces at both the vehicle body and the side protect moulding.

Body 40 – 60°C

Side protect moulding 20 – 30°C

Apply pressure fully to the side protect moulding.

2. Installation position

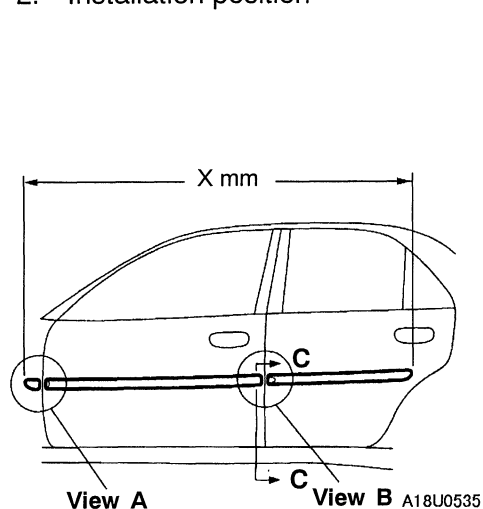

View A

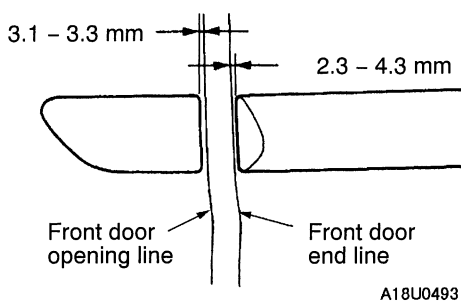

View B

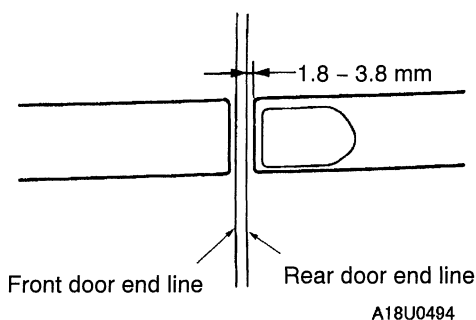

Section C-C

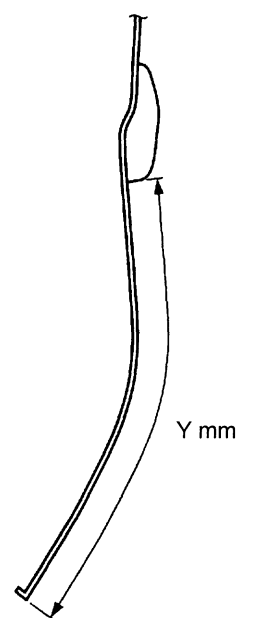

X	Y
493	186.6 ± 1
1525	216.5 ± 1
1546	217.3 ± 1
2000	221.3 ± 1

WINDSHIELD WIPER AND WASHER

REMOVAL AND INSTALLATION

Pre-removal and Post-installation Operation

- Relay Box Removal and Installation
<R.H. drive vehicles>

CAUTION: SRS

Before removal of air bag module and clock spring, refer to GROUP 52B - SRS Service Precautions and Air Bag Module and Clock Spring.

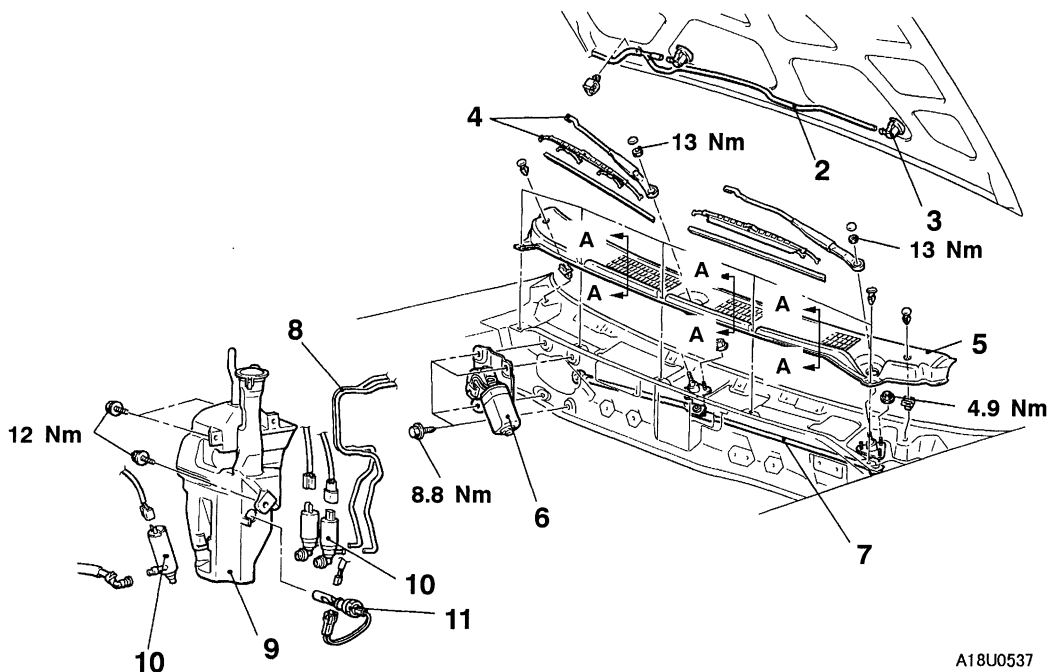

A18U0537

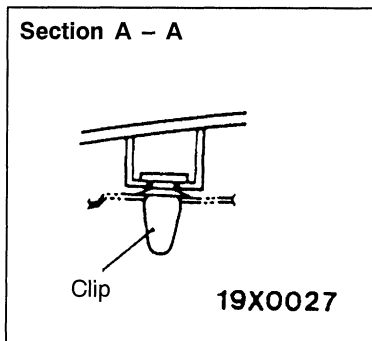
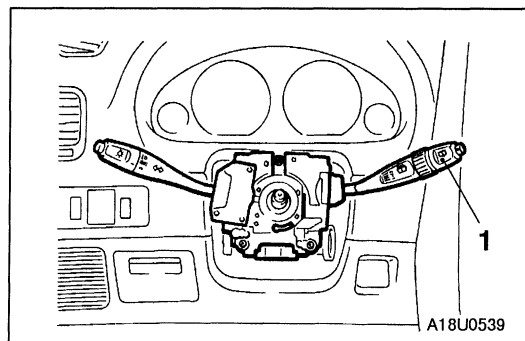

1. Column switch assembly
(with built-in wiper and washer switch, and wiper relay)
(Refer to GROUP 37A - Steering wheel and shaft.)
2. Washer hose
3. Washer nozzle

Washer tank removal steps

- Draining of washer fluid
- Front bumper (Refer to P.51-2.)
- 8. Washer hose
- 9. Washer tank
- 10. Washer motor
- 11. Washer fluid level switch

Wiper motor and linkage removal steps

4. Wiper arm and blade assembly
5. Front deck garnish
6. Wiper motor
7. Linkage

◀A▶

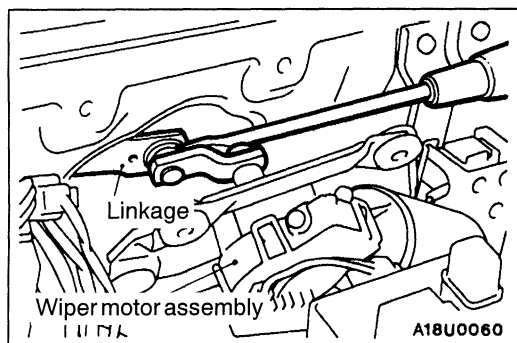
**REMOVAL SERVICE POINT****◀A▶ WIPER MOTOR REMOVAL**

Loosen the wiper motor assembly mounting bolts, and then remove the wiper motor assembly. Disconnect the linkage and the motor assembly, and then remove the linkage.

Caution

Because the installation angle of the crank arm and the motor has been set, do not remove them unless it is necessary to do so. If they must be removed, remove them only after marking their mounting positions.

INSTALLATION SERVICE POINT**▶A◀ WIPER ARM AND BLADE ASSEMBLY INSTALLATION**

- (1) The movements of the left and right wiper arms are different, so check the identification marks.
- (2) Install the wiper blade in the specified position (standard value) as shown in the illustration.

Standard value:

Passenger's side (A): 20 ± 5 mm

Driver's side (B): 25 ± 5 mm

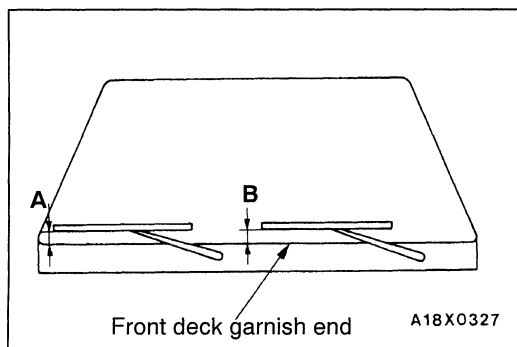

REAR WIPER AND WASHER <HATCHBACK>

REMOVAL AND INSTALLATION

CAUTION: SRS

Before removal of air bag module and clock spring, refer to GROUP 52B - SRS Service Precautions and Air Bag Module and Clock Spring.

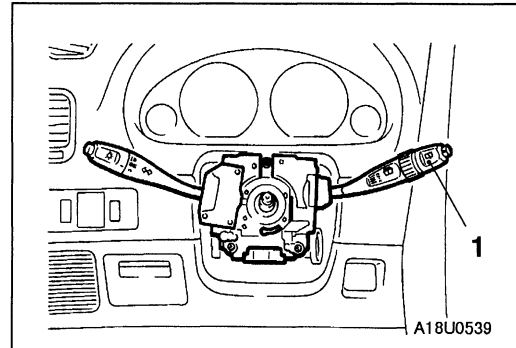
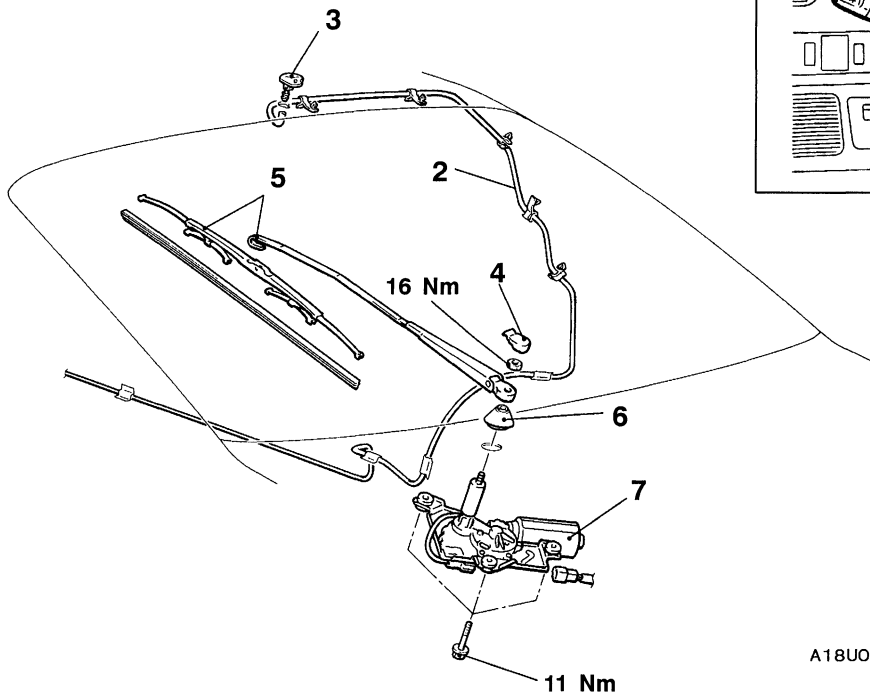

A18U0519

1. Column switch assembly
(with built-in rear wiper and washer switch)
(Refer to GROUP 37A – Steering wheel and shaft.)
2. Washer hose
3. Washer nozzle

Wiper motor removal steps

4. Cover
5. Wiper arm and blade
6. Grommet
7. Wiper motor

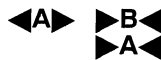

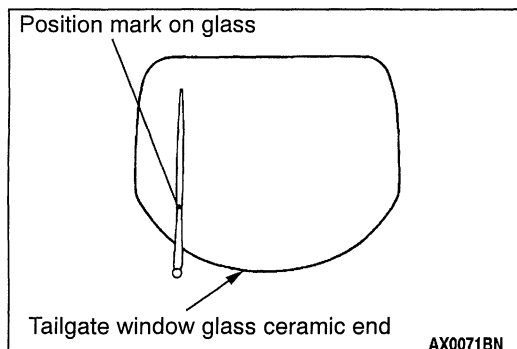
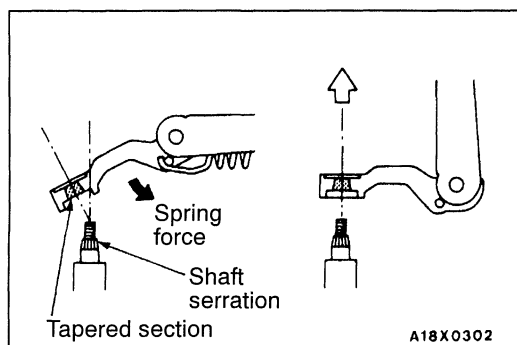

REMOVAL SERVICE POINT

◀A▶ WIPER ARM AND BLADE REMOVAL

Remove the wiper arm from the shaft while the wiper arm is raised.

Caution

If the wiper arm is forced while it is still lowered, the tapered section of the wiper arm will be scraped by the shaft serrations and the diameter of the tapered section will become too big, so sufficient care should be exercised.

INSTALLATION SERVICE POINT

▶A◀ WIPER ARM ASSEMBLY INSTALLATION

Align the wiper blade with the position mark to secure the wiper arm.

HEADLAMP WASHER

REMOVAL AND INSTALLATION

CAUTION: SRS

Before removal of air bag module and clock spring, refer to GROUP 52B - SRS Service Precautions and Air Bag Module and Clock Spring.

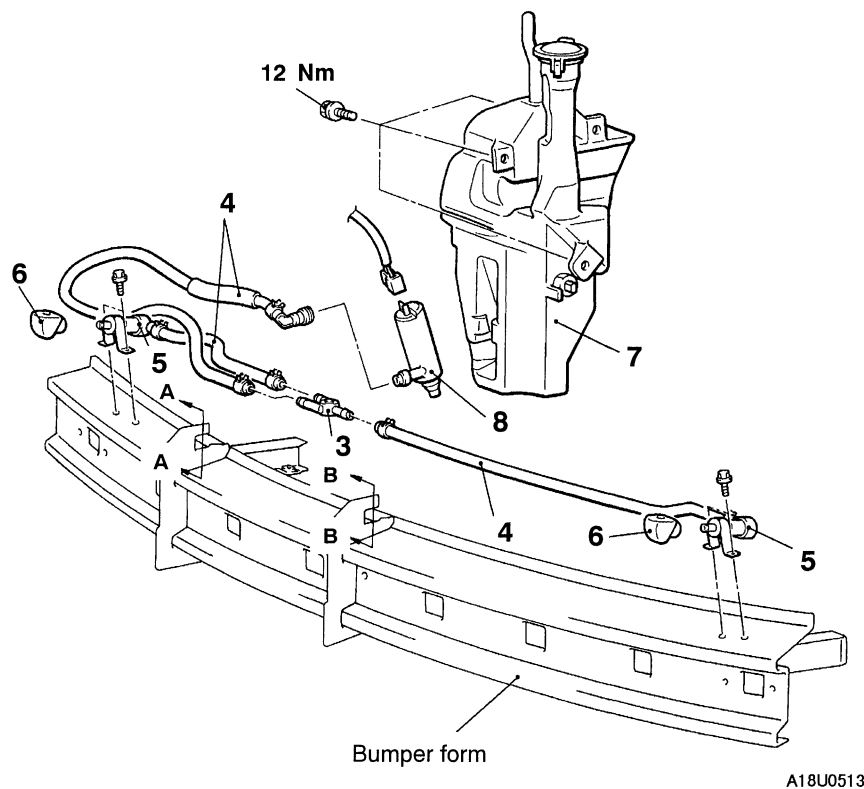

Section A - A

Section B - B

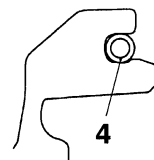
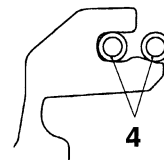

A18U0538

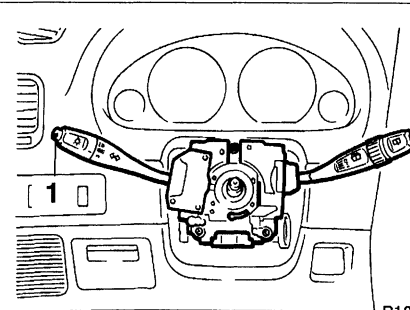

B18I0539

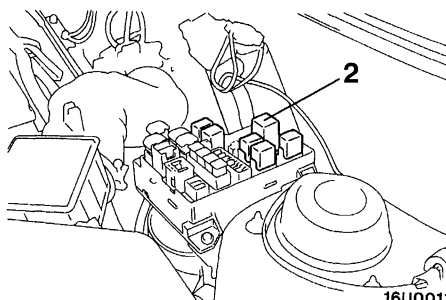

16U0011

1. Column switch assembly (with built-in headlamp washer switch) (Refer to GROUP 37A - Steering Wheel and Shaft.)
2. Headlamp washer relay

Telescopic and Y connector removal steps

- Draining of washer fluid
- Front bumper (Refer to P.51-2.)
- 3. Y connector
- 4. Washer hose assembly
- 5. Telescopic assembly
- 6. Eyeball holder and cover

Washer tank removal steps

- Draining of washer fluid
- Front bumper (Refer to P.51-2.)
- 7. Washer tank assembly
- 8. Headlamp washer motor

MARKS

REMOVAL AND INSTALLATION

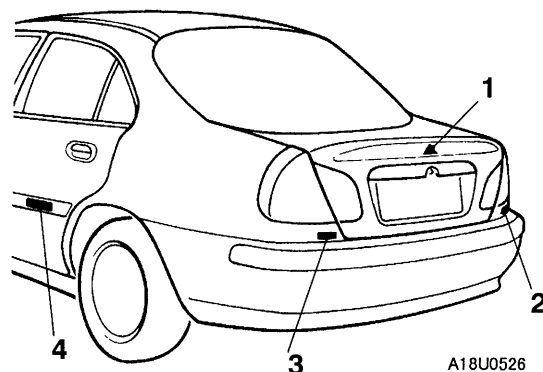
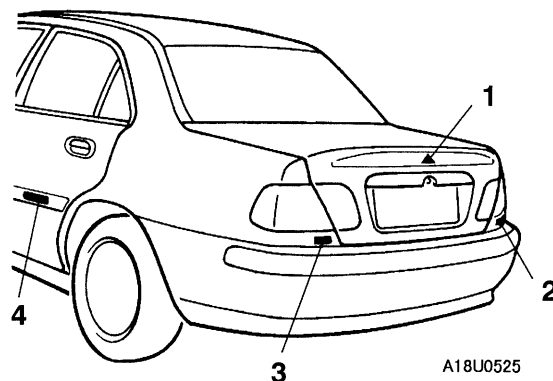
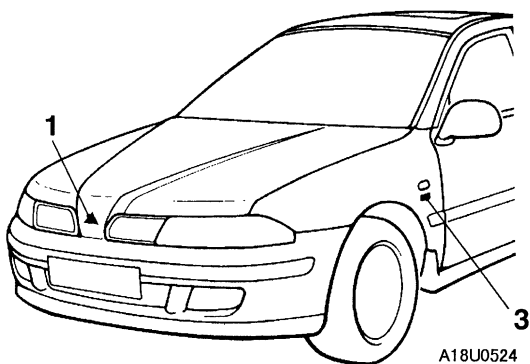

- ▶A◀ 1. Three Diamond MARK
▶A◀ 2. CARISMA MARK

- ▶A◀ 3. GDI MARK
▶A◀ 4. GRADE MARK

INSTALLATION SERVICE POINT

▶A◀ MARK INSTALLATION

(1) Three Diamond MARK

<Front>

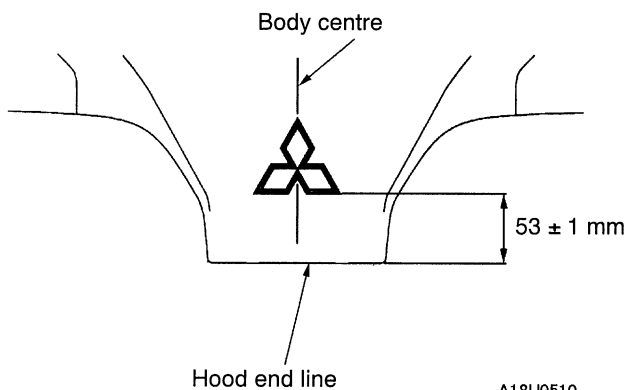

<Rear>

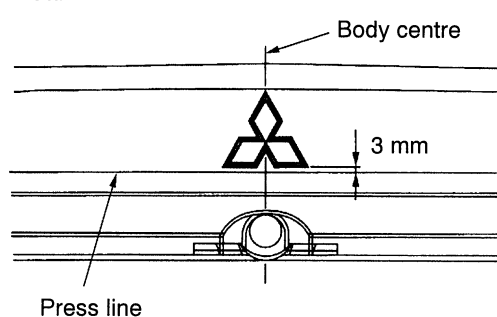

A18U0511

(2) CARISMA MARK

<Sedan>

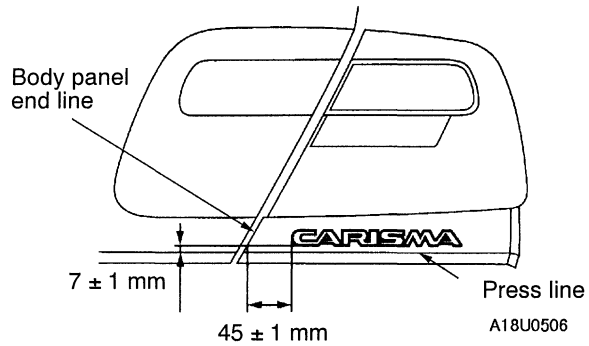

<Hatchback>

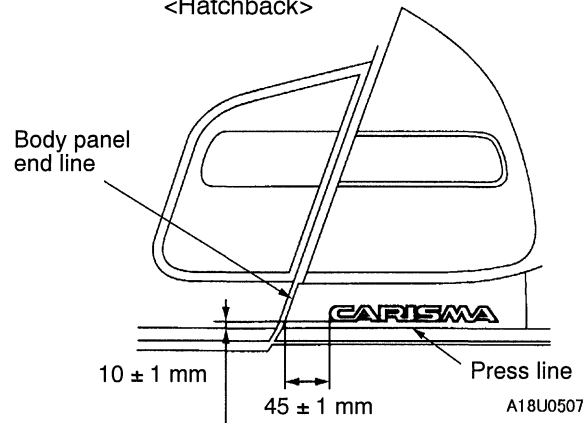

(3) GDI MARK

{Side}

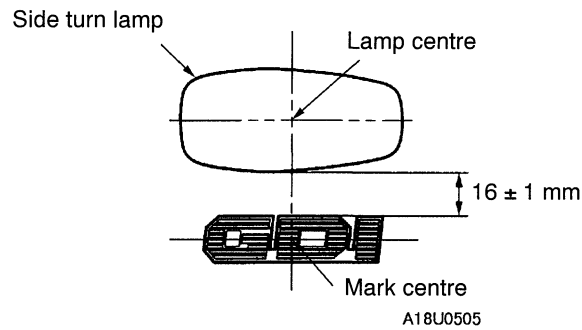

{Rear}

<Sedan>

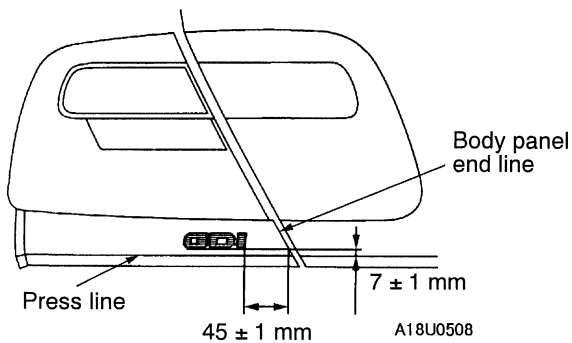

<Hatchback>

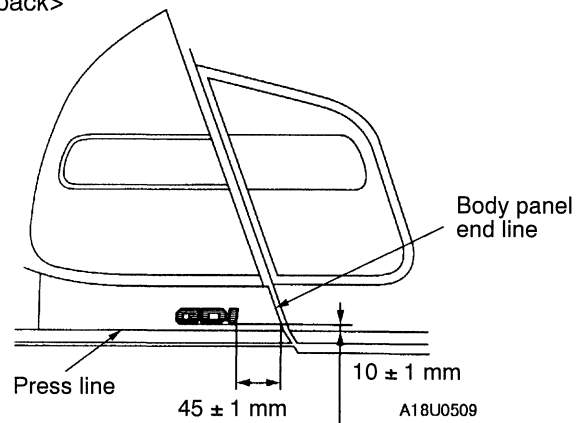

(4) GRADE MARK

<CARISMA, CLASSIC, COMFORT, SPORT, ELEGANCE>

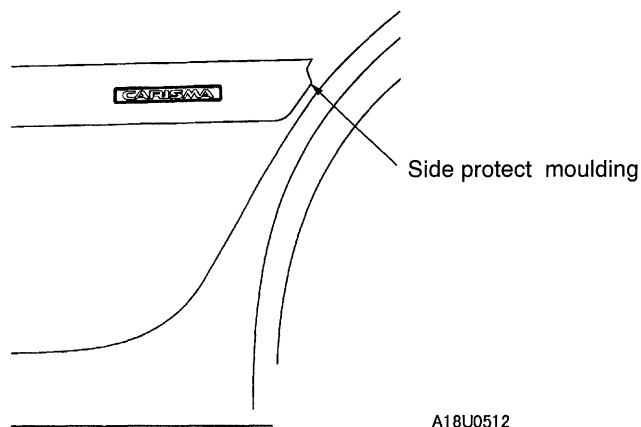
**MARKS INSTALLATION**

1. Clean the mark installation surfaces on the body with unleaded petrol.
2. Peel off the backing paper from the reverse side of the marks, and then attach the marks to the vehicle body so that they fit properly position.

Caution

When attaching the marks, the surrounding temperature should be 20 – 38°C and the air should be completely free from dust.

If the surrounding temperature is lower than 20°C, the marks and the places on the body where the marks are to be attached should be heated to 20 – 38°C.

DOOR MIRROR

REMOVAL AND INSTALLATION

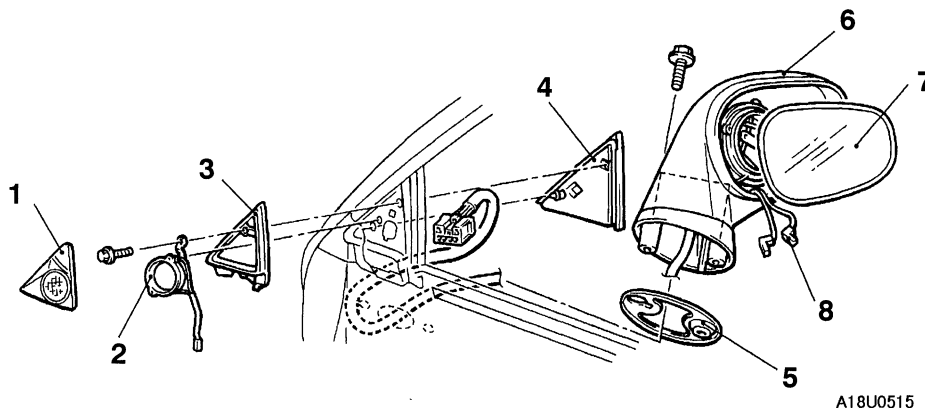

A18U0515

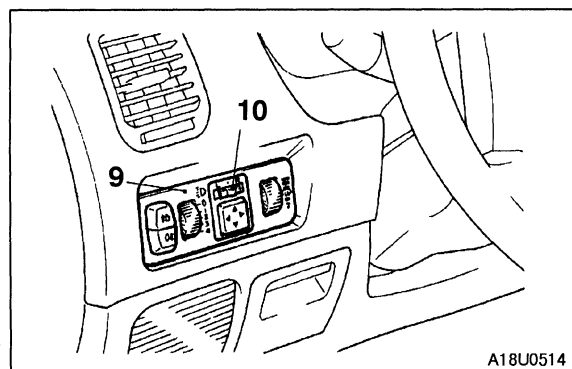

A18U0514

Door mirror removal steps

- Front door trim (Refer to GROUP 42)
- 1. Delta cover, inner
- 2. Tweeter assembly
- 3. Delta cover, inner flame
- 4. Delta cover, outer
- 5. Gasket
- 6. Door mirror
- 7. Mirror
- 8. Harness connector

Door mirror control switch removal steps

- 9. Instrument panel switch assembly
- 10. Door mirror control switch

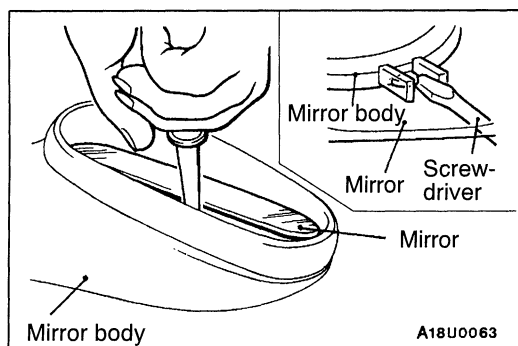

A18U0063

REMOVAL SERVICE POINT

◀A▶ MIRROR REMOVAL

Turn the mirror by hand so that it faces upwards, insert the flat-tipped screwdriver wound with masking tape into the notched section, and lever out the mirror to remove it.

NOTES